

BLOCK PLAN FOR GROUND FLOOR
SCALE: 1/8" = 1'-0"

BLOCK PLAN FOR FIRST & SECOND FLOOR
SCALE: 1/8" = 1'-0"

Prepared by
S. S. S. S. S.
Checked by
S. S. S. S. S.

NO.	DESCRIPTION	DATE
1
2
3
4
5

PROJECT TITLE:
COLLEGE BUILDING FOR
BALLABHAI INSTITUTE OF TECHNOLOGY
ON P.W. NO. 2752-2753-2754-2755-2756-2757-2758-2759-2760-2761-2762-2763-2764-2765-2766-2767-2768-2769-2770-2771-2772-2773-2774-2775-2776-2777-2778-2779-2780-2781-2782-2783-2784-2785-2786-2787-2788-2789-2790-2791-2792-2793-2794-2795-2796-2797-2798-2799-2800-2801-2802-2803-2804-2805-2806-2807-2808-2809-2810-2811-2812-2813-2814-2815-2816-2817-2818-2819-2820-2821-2822-2823-2824-2825-2826-2827-2828-2829-2830-2831-2832-2833-2834-2835-2836-2837-2838-2839-2840-2841-2842-2843-2844-2845-2846-2847-2848-2849-2850-2851-2852-2853-2854-2855-2856-2857-2858-2859-2860-2861-2862-2863-2864-2865-2866-2867-2868-2869-2870-2871-2872-2873-2874-2875-2876-2877-2878-2879-2880-2881-2882-2883-2884-2885-2886-2887-2888-2889-2890-2891-2892-2893-2894-2895-2896-2897-2898-2899-2900-2901-2902-2903-2904-2905-2906-2907-2908-2909-2910-2911-2912-2913-2914-2915-2916-2917-2918-2919-2920-2921-2922-2923-2924-2925-2926-2927-2928-2929-2930-2931-2932-2933-2934-2935-2936-2937-2938-2939-2940-2941-2942-2943-2944-2945-2946-2947-2948-2949-2950-2951-2952-2953-2954-2955-2956-2957-2958-2959-2960-2961-2962-2963-2964-2965-2966-2967-2968-2969-2970-2971-2972-2973-2974-2975-2976-2977-2978-2979-2980-2981-2982-2983-2984-2985-2986-2987-2988-2989-2990-2991-2992-2993-2994-2995-2996-2997-2998-2999-3000

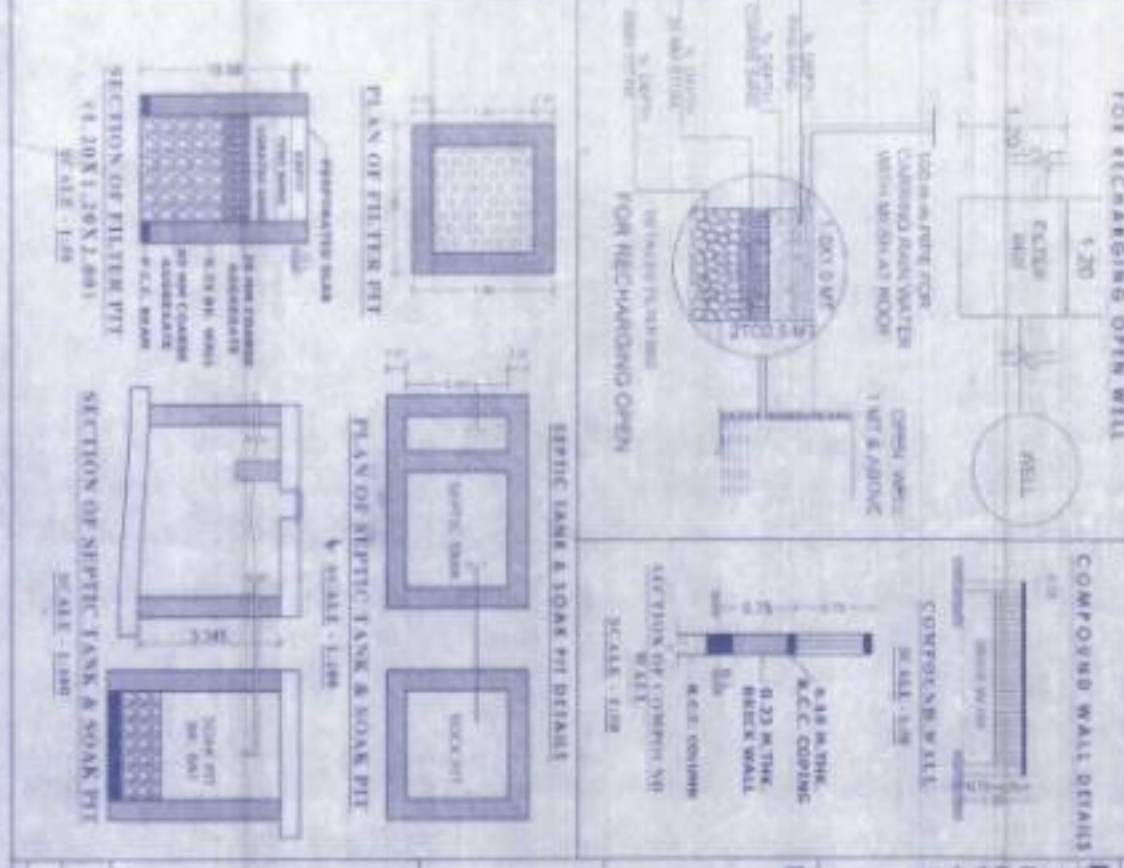

PROJECT TITLE:
COLLEGE BUILDING FOR
BALLABHAI INSTITUTE OF TECHNOLOGY
ON P.W. NO. 2752-2753-2754-2755-2756-2757-2758-2759-2760-2761-2762-2763-2764-2765-2766-2767-2768-2769-2770-2771-2772-2773-2774-2775-2776-2777-2778-2779-2780-2781-2782-2783-2784-2785-2786-2787-2788-2789-2790-2791-2792-2793-2794-2795-2796-2797-2798-2799-2800-2801-2802-2803-2804-2805-2806-2807-2808-2809-2810-2811-2812-2813-2814-2815-2816-2817-2818-2819-2820-2821-2822-2823-2824-2825-2826-2827-2828-2829-2830-2831-2832-2833-2834-2835-2836-2837-2838-2839-2840-2841-2842-2843-2844-2845-2846-2847-2848-2849-2850-2851-2852-2853-2854-2855-2856-2857-2858-2859-2860-2861-2862-2863-2864-2865-2866-2867-2868-2869-2870-2871-2872-2873-2874-2875-2876-2877-2878-2879-2880-2881-2882-2883-2884-2885-2886-2887-2888-2889-2890-2891-2892-2893-2894-2895-2896-2897-2898-2899-2900-2901-2902-2903-2904-2905-2906-2907-2908-2909-2910-2911-2912-2913-2914-2915-2916-2917-2918-2919-2920-2921-2922-2923-2924-2925-2926-2927-2928-2929-2930-2931-2932-2933-2934-2935-2936-2937-2938-2939-2940-2941-2942-2943-2944-2945-2946-2947-2948-2949-2950-2951-2952-2953-2954-2955-2956-2957-2958-2959-2960-2961-2962-2963-2964-2965-2966-2967-2968-2969-2970-2971-2972-2973-2974-2975-2976-2977-2978-2979-2980-2981-2982-2983-2984-2985-2986-2987-2988-2989-2990-2991-2992-2993-2994-2995-2996-2997-2998-2999-3000

ARCHITECT'S SIGN
PROJECT NO. 100/101/102/103/104/105/106/107/108/109/110/111/112/113/114/115/116/117/118/119/120/121/122/123/124/125/126/127/128/129/130/131/132/133/134/135/136/137/138/139/140/141/142/143/144/145/146/147/148/149/150/151/152/153/154/155/156/157/158/159/160/161/162/163/164/165/166/167/168/169/170/171/172/173/174/175/176/177/178/179/180/181/182/183/184/185/186/187/188/189/190/191/192/193/194/195/196/197/198/199/200/201/202/203/204/205/206/207/208/209/210/211/212/213/214/215/216/217/218/219/220/221/222/223/224/225/226/227/228/229/230/231/232/233/234/235/236/237/238/239/240/241/242/243/244/245/246/247/248/249/250/251/252/253/254/255/256/257/258/259/260/261/262/263/264/265/266/267/268/269/270/271/272/273/274/275/276/277/278/279/280/281/282/283/284/285/286/287/288/289/290/291/292/293/294/295/296/297/298/299/300

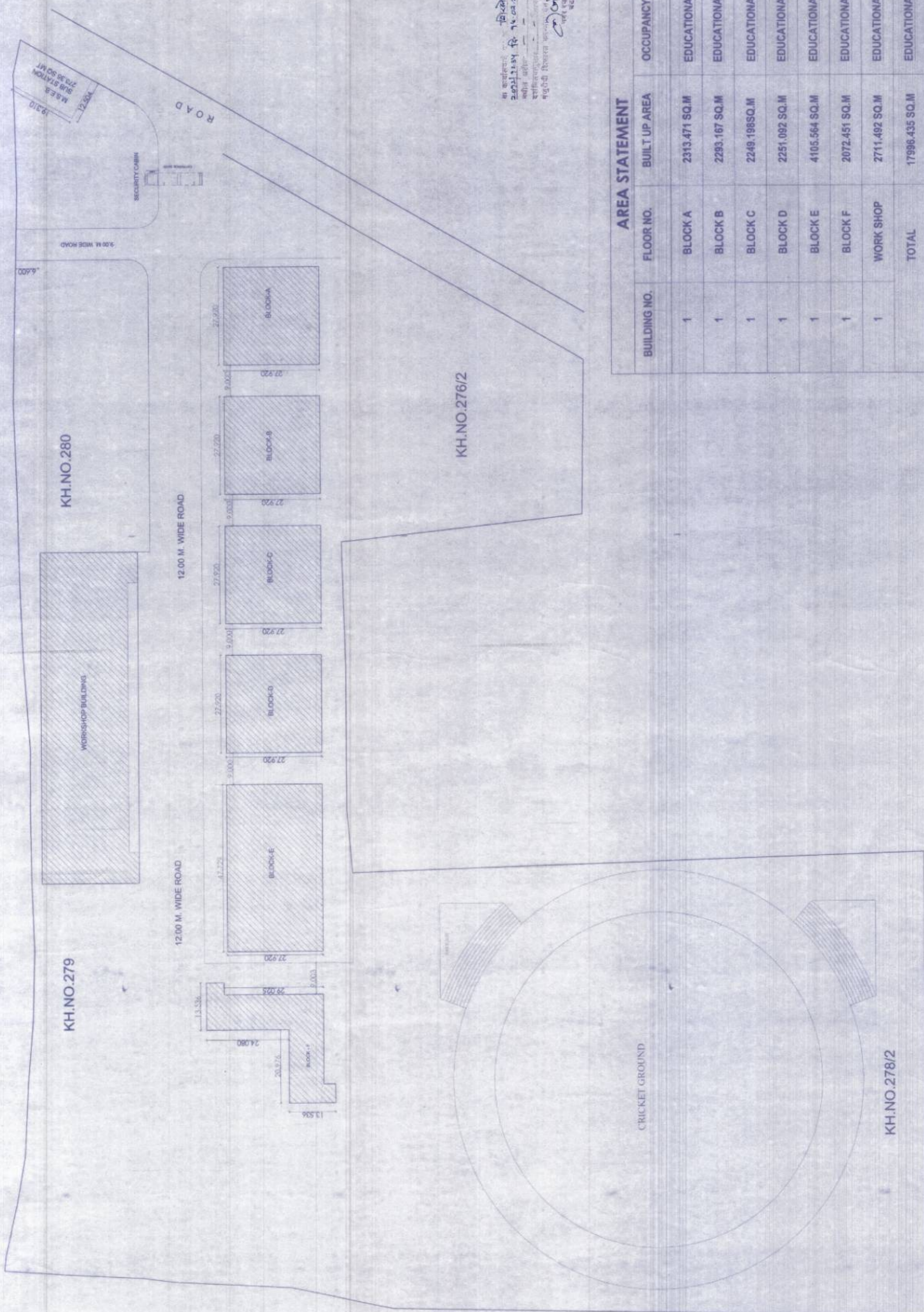

श्री कृष्ण जीवन् विकास
 प्रशिक्षण संस्थान
 कोल्लारपुर, तालुका - बामनी
 जिल्हा - चंद्रपूर
 महाराष्ट्र

PROJECT TITLE :
 COLLEGE BUILDING FOR
 BALLARPUR INSTITUTE OF TECHNOLOGY
 ON KH.NO.-276/2, 278, 279, 280,
 VILLAGE - BAMNI
 TALUKA - BALLARPUR,
 DIST:- CHANDRAPUR

BELONGING TO :-
 KRUSHI JIVAN VIKAS
 PRATISHTHAN, YENBODI
 OWNER/CLIENT'S SIGN :

ARCHITECT'S SIGN
 PRASHANT SATPUTE
 8, APN, JYONESHWAY, M.S.
 REG. NO. CA-8113288
 S.C.A.E. No.1-23

AREA STATEMENT			
BUILDING NO.	FLOOR NO.	BUILT UP AREA	OCCUPANCY
1	BLOCK A	2313.471 SQ.M	EDUCATIONAL
1	BLOCK B	2293.167 SQ.M	EDUCATIONAL
1	BLOCK C	2249.198 SQ.M	EDUCATIONAL
1	BLOCK D	2251.092 SQ.M	EDUCATIONAL
1	BLOCK E	4105.564 SQ.M	EDUCATIONAL
1	BLOCK F	2072.451 SQ.M	EDUCATIONAL
1	WORK SHOP	2711.492 SQ.M	EDUCATIONAL
TOTAL		17996.435 SQ.M	EDUCATIONAL
BASIC FSI		60702.341 X 1.10	= 66772.575



PROJECT TITLE:
COLLEGE BUILDING FOR
MALLAPURAM INSTITUTE OF TECHNOLOGY
ORIPALM-3762 2362 275 386
VILLAGE - SAMM
TALUKA - MALLAPPUR
DIST - CHANDRAPHUR

BELONGING TO

KRISHI JIVAN VIKAS
PRATHISTHAN, YENBODI
CHANDRAPHUR DIST.

DATE: 15/08/2018

PROJECT NO: 18/08/2018
SCALE: 1/2" = 1'-0"



SCHEDULE FOR CURING

NO.	NO.	DATE	REMARKS
1	1	15/08/2018	WORKING
2	2	16/08/2018	WORKING
3	3	17/08/2018	WORKING
4	4	18/08/2018	WORKING
5	5	19/08/2018	WORKING
6	6	20/08/2018	WORKING
7	7	21/08/2018	WORKING
8	8	22/08/2018	WORKING
9	9	23/08/2018	WORKING
10	10	24/08/2018	WORKING
11	11	25/08/2018	WORKING
12	12	26/08/2018	WORKING
13	13	27/08/2018	WORKING
14	14	28/08/2018	WORKING
15	15	29/08/2018	WORKING
16	16	30/08/2018	WORKING
17	17	31/08/2018	WORKING
18	18	01/09/2018	WORKING
19	19	02/09/2018	WORKING
20	20	03/09/2018	WORKING
21	21	04/09/2018	WORKING
22	22	05/09/2018	WORKING
23	23	06/09/2018	WORKING
24	24	07/09/2018	WORKING
25	25	08/09/2018	WORKING
26	26	09/09/2018	WORKING
27	27	10/09/2018	WORKING
28	28	11/09/2018	WORKING
29	29	12/09/2018	WORKING
30	30	13/09/2018	WORKING
31	31	14/09/2018	WORKING
32	32	15/09/2018	WORKING
33	33	16/09/2018	WORKING
34	34	17/09/2018	WORKING
35	35	18/09/2018	WORKING
36	36	19/09/2018	WORKING
37	37	20/09/2018	WORKING
38	38	21/09/2018	WORKING
39	39	22/09/2018	WORKING
40	40	23/09/2018	WORKING
41	41	24/09/2018	WORKING
42	42	25/09/2018	WORKING
43	43	26/09/2018	WORKING
44	44	27/09/2018	WORKING
45	45	28/09/2018	WORKING
46	46	29/09/2018	WORKING
47	47	30/09/2018	WORKING
48	48	01/10/2018	WORKING
49	49	02/10/2018	WORKING
50	50	03/10/2018	WORKING
51	51	04/10/2018	WORKING
52	52	05/10/2018	WORKING
53	53	06/10/2018	WORKING
54	54	07/10/2018	WORKING
55	55	08/10/2018	WORKING
56	56	09/10/2018	WORKING
57	57	10/10/2018	WORKING
58	58	11/10/2018	WORKING
59	59	12/10/2018	WORKING
60	60	13/10/2018	WORKING
61	61	14/10/2018	WORKING
62	62	15/10/2018	WORKING
63	63	16/10/2018	WORKING
64	64	17/10/2018	WORKING
65	65	18/10/2018	WORKING
66	66	19/10/2018	WORKING
67	67	20/10/2018	WORKING
68	68	21/10/2018	WORKING
69	69	22/10/2018	WORKING
70	70	23/10/2018	WORKING
71	71	24/10/2018	WORKING
72	72	25/10/2018	WORKING
73	73	26/10/2018	WORKING
74	74	27/10/2018	WORKING
75	75	28/10/2018	WORKING
76	76	29/10/2018	WORKING
77	77	30/10/2018	WORKING
78	78	31/10/2018	WORKING
79	79	01/11/2018	WORKING
80	80	02/11/2018	WORKING
81	81	03/11/2018	WORKING
82	82	04/11/2018	WORKING
83	83	05/11/2018	WORKING
84	84	06/11/2018	WORKING
85	85	07/11/2018	WORKING
86	86	08/11/2018	WORKING
87	87	09/11/2018	WORKING
88	88	10/11/2018	WORKING
89	89	11/11/2018	WORKING
90	90	12/11/2018	WORKING
91	91	13/11/2018	WORKING
92	92	14/11/2018	WORKING
93	93	15/11/2018	WORKING
94	94	16/11/2018	WORKING
95	95	17/11/2018	WORKING
96	96	18/11/2018	WORKING
97	97	19/11/2018	WORKING
98	98	20/11/2018	WORKING
99	99	21/11/2018	WORKING
100	100	22/11/2018	WORKING
101	101	23/11/2018	WORKING
102	102	24/11/2018	WORKING
103	103	25/11/2018	WORKING
104	104	26/11/2018	WORKING
105	105	27/11/2018	WORKING
106	106	28/11/2018	WORKING
107	107	29/11/2018	WORKING
108	108	30/11/2018	WORKING
109	109	01/12/2018	WORKING
110	110	02/12/2018	WORKING
111	111	03/12/2018	WORKING
112	112	04/12/2018	WORKING
113	113	05/12/2018	WORKING
114	114	06/12/2018	WORKING
115	115	07/12/2018	WORKING
116	116	08/12/2018	WORKING
117	117	09/12/2018	WORKING
118	118	10/12/2018	WORKING
119	119	11/12/2018	WORKING
120	120	12/12/2018	WORKING
121	121	13/12/2018	WORKING
122	122	14/12/2018	WORKING
123	123	15/12/2018	WORKING
124	124	16/12/2018	WORKING
125	125	17/12/2018	WORKING
126	126	18/12/2018	WORKING
127	127	19/12/2018	WORKING
128	128	20/12/2018	WORKING
129	129	21/12/2018	WORKING
130	130	22/12/2018	WORKING
131	131	23/12/2018	WORKING
132	132	24/12/2018	WORKING
133	133	25/12/2018	WORKING
134	134	26/12/2018	WORKING
135	135	27/12/2018	WORKING
136	136	28/12/2018	WORKING
137	137	29/12/2018	WORKING
138	138	30/12/2018	WORKING
139	139	31/12/2018	WORKING
140	140	01/01/2019	WORKING
141	141	02/01/2019	WORKING
142	142	03/01/2019	WORKING
143	143	04/01/2019	WORKING
144	144	05/01/2019	WORKING
145	145	06/01/2019	WORKING
146	146	07/01/2019	WORKING
147	147	08/01/2019	WORKING
148	148	09/01/2019	WORKING
149	149	10/01/2019	WORKING
150	150	11/01/2019	WORKING
151	151	12/01/2019	WORKING
152	152	13/01/2019	WORKING
153	153	14/01/2019	WORKING
154	154	15/01/2019	WORKING
155	155	16/01/2019	WORKING
156	156	17/01/2019	WORKING
157	157	18/01/2019	WORKING
158	158	19/01/2019	WORKING
159	159	20/01/2019	WORKING
160	160	21/01/2019	WORKING
161	161	22/01/2019	WORKING
162	162	23/01/2019	WORKING
163	163	24/01/2019	WORKING
164	164	25/01/2019	WORKING
165	165	26/01/2019	WORKING
166	166	27/01/2019	WORKING
167	167	28/01/2019	WORKING
168	168	29/01/2019	WORKING
169	169	30/01/2019	WORKING
170	170	31/01/2019	WORKING
171	171	01/02/2019	WORKING
172	172	02/02/2019	WORKING
173	173	03/02/2019	WORKING
174	174	04/02/2019	WORKING
175	175	05/02/2019	WORKING
176	176	06/02/2019	WORKING
177	177	07/02/2019	WORKING
178	178	08/02/2019	WORKING
179	179	09/02/2019	WORKING
180	180	10/02/2019	WORKING
181	181	11/02/2019	WORKING
182	182	12/02/2019	WORKING
183	183	13/02/2019	WORKING
184	184	14/02/2019	WORKING
185	185	15/02/2019	WORKING
186	186	16/02/2019	WORKING
187	187	17/02/2019	WORKING
188	188	18/02/2019	WORKING
189	189	19/02/2019	WORKING
190	190	20/02/2019	WORKING
191	191	21/02/2019	WORKING
192	192	22/02/2019	WORKING
193	193	23/02/2019	WORKING
194	194	24/02/2019	WORKING
195	195	25/02/2019	WORKING
196	196	26/02/2019	WORKING
197	197	27/02/2019	WORKING
198	198	28/02/2019	WORKING
199	199	29/02/2019	WORKING
200	200	30/02/2019	WORKING
201	201	01/03/2019	WORKING
202	202	02/03/2019	WORKING
203	203	03/03/2019	WORKING
204	204	04/03/2019	WORKING
205	205	05/03/2019	WORKING
206	206	06/03/2019	WORKING
207	207	07/03/2019	WORKING
208	208	08/03/2019	WORKING
209	209	09/03/2019	WORKING
210	210	10/03/2019	WORKING
211	211	11/03/2019	WORKING
212	212	12/03/2019	WORKING
213	213	13/03/2019	WORKING
214	214	14/03/2019	WORKING
215	215	15/03/2019	WORKING
216	216	16/03/2019	WORKING
217	217	17/03/2019	WORKING
218	218	18/03/2019	WORKING
219	219	19/03/2019	WORKING
220	220	20/03/2019	WORKING
221	221	21/03/2019	WORKING
222	222	22/03/2019	WORKING
223	223	23/03/2019	WORKING
224	224	24/03/2019	WORKING
225	225	25/03/2019	WORKING
226	226	26/03/2019	WORKING
227	227	27/03/2019	WORKING
228	228	28/03/2019	WORKING
229	229	29/03/2019	WORKING
230	230	30/03/2019	WORKING
231	231	31/03/2019	WORKING
232	232	01/04/2019	WORKING
233	233	02/04/2019	WORKING
234	234	03/04/2019	WORKING
235	235	04/04/2019	WORKING
236	236	05/04/2019	WORKING
237	237	06/04/2019	WORKING
238	238	07/04/2019	WORKING
239	239	08/04/2019	WORKING
240	240	09/04/2019	WORKING
241	241	10/04/2019	WORKING
242	242		